

SNOWFLAKE

1. Cut out paper folding square leaving no border.
2. Fold it corner to opposite corner with the image inside. Open and repeat with the other opposite corners.
3. Open it again. This time fold it in half, top edge to bottom edge with image on the outside. Open and repeat but with left edge to right edge.
4. Open it and your paper folds should look like the photo.
5. Fold both sets of opposite corners towards each other so that you create 2 overlapping squares, each with 2 sides open.
6. Flatten this so that you end up with the square shape in the picture.
7. Take the left and right corners of the top square and fold towards the central line creating a petal shape.
8. Cut out the centre of a different folding square. You will notice that being a snowflake design there is a hexagon in the centre (6 sides).
9. Glue the square with the open sides facing outward on to this centre piece, placing it approximately 6 mm from the central point and opposite the middle of a hexagon side.
10. Repeat this with 5 other folding squares, and line each of them up to the centre of a side of the hexagon. They will each overlap the previous square. All together you have a snowflake pattern.

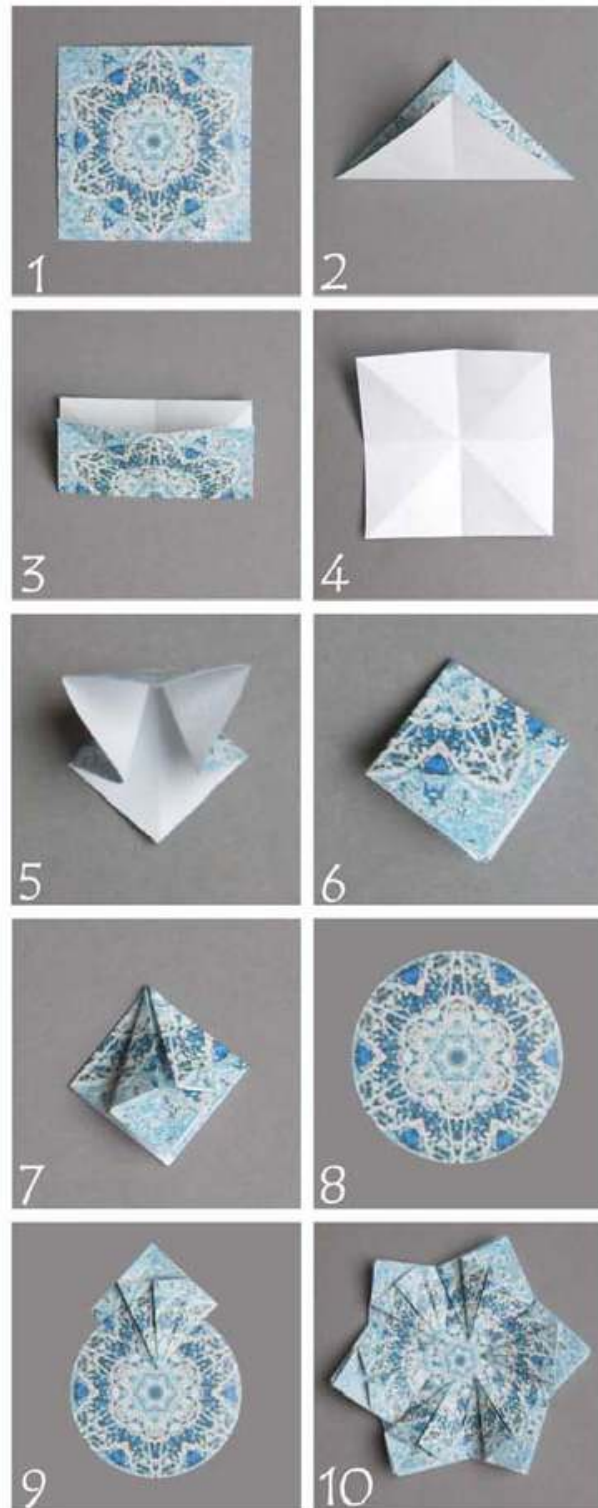

BEAUTY PONDER

If beauty is in the eyes of the beholder, how is it that I might become a person who sees beauty everywhere, especially in the small things of living?